

# Product leaflet

**Product**  
Test adapter

**Model No.**  
SR 328

**Ordering No.**  
T01-1202

## Product Description

The SR 328 test adapter is used for connecting the SR 90-3 / SR 100 / SR 900 half mask to a measuring instrument for carrying out a facial fit testing. The adapter is connected to one of the exhalation valves of the mask.

The adapter is intended for use only for facial fit testing under test conditions. It must not be used under real work conditions.

- A. Valve seat of the mask
- B. Adapter
- C. Hose
- D. Exhalation valve membrane
- E. Valve cover

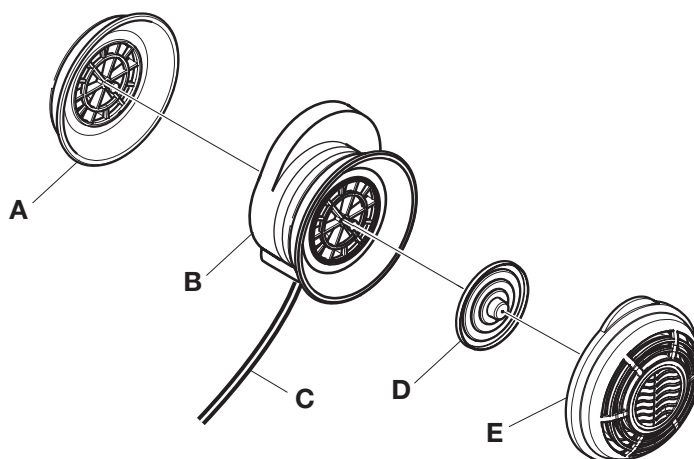

**Head Office**

Tel: +46 10 484 87 00

Visiting address:  
Stockholmsvägen 33  
SE-181 33 Lidingö

**Factory**

Tel: +46 10 484 87 00

Visiting address:  
Västergatan 4  
SE-341 50 Lagan

**Sundström**   
www.srsafety.com